

Thank you for purchasing our product. Please read through the manual prior to starting using the product.

- This manual contains product warranty. Please fill up the warranty with details on installation shop, contact information and data of installation to receive A/S under warranty.
- Product features and design may change without prior notification in order to improve product quality.

- The images contained in this manual are only reference used for description and instruction and its types and colors may differ in accordance with the product model.

Safety cautions

-  **Do not dismantle the product yourself. It causes malfunction of product.** If you dismantle the product yourself, the product may not function as it should.
Prohibited
-  **Do not impact on or alter the product.** It may cause malfunction or abnormal operation.
Prohibited
-  **Do not use the product in place with water or humidity.** Since the product does not have water and dust proof structure, it may cause product malfunction due to short circuit, etc.
Caution
-  **Completely block holes on door after product installation.** There is a risk of intrusion through milk hole or other door holes.
Caution
-  **Do not place inflammables such as gas lighter near the product.** It may cause malfunction or abnormal operation.
Caution
-  **Do not use the product in place with direct sunlight or high temperature.** It may cause malfunction or abnormal operation.
Prohibited
-  **Do not install the product in place which water like snow or rain can come through in.** It may cause malfunction or abnormal operation.
Prohibited
-  **Do not directly spray water when cleaning the product.** Water coming through into the product causes malfunction or abnormal operation.
Prohibited
-  **Replace all batteries with new one when changing batteries.** When changing batteries, replace all batteries with new one. If using old batteries together new one, product life span cannot be guaranteed and product may malfunction.
Caution
-  **Use alkaline battery only.** Using rechargeable battery may cause product malfunction.
Caution

Keypad Deadbolt

Caution

Since the product is keyless door lock, a part of door lock may need to be damaged in case of malfunction.
It needs to be familiar with how to use manual closing and opening device in case of emergency.

1. Voltage: DC6V / 2. Be cautious that reverse installation of batteries causes liquid leakage or a burst.
3. When battery is flat, replace all batteries and DO NOT use used batteries with new one.
4. Sensor operation temperature: 60°C (±10°C)

Product Structure and Name

Outdoor body (Types and colors of outdoor body will differ depending on the model.)

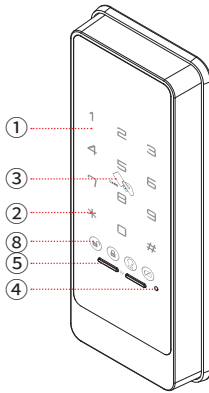

Touchpad type

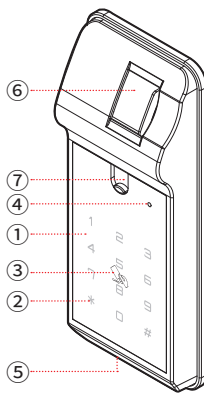

Fingerprint recognition type

- ① Touch keypad
- ② Start/End button
- ③ Card/Key tag input
- ④ Reset button
- ⑤ 9V emergency power supply socket
- ⑥ Fingerprint input
- ⑦ Emergency key hole
- ⑧ External alarm icon (Applied model)

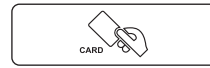

Card / Key tag input part

Basic components (Check if your product contains all contents.)

1 outdoor body / 1 indoor body /
1 user manual / 1 installation guide /
Bolt set / 4 AA batteries (Alkaline)

Caution

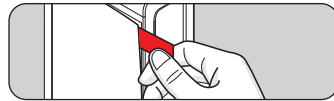

※Remove the protection tape on the touch pad after digital door lock installation

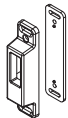

General type
Front/Pad (Latch) 1EA

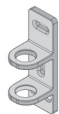

Hook type

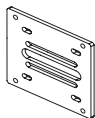

General type
Internal steel panel 1EA

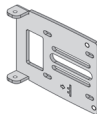

Hook type

Extra accessories (Applied model)



Anti-metal
card



Small card
(Tag)



Emergency
key

Optional accessory sold separately

(Applied model with remote control)



Remote control

※Basic components (Extra accessories) and its quantity may differ depending on the product model (Opening/closing function)
※Types and colors of card/key tag (Remote control) may change.

■ **Indoor body** (Types and colors of indoor body will differ depending on the model.)

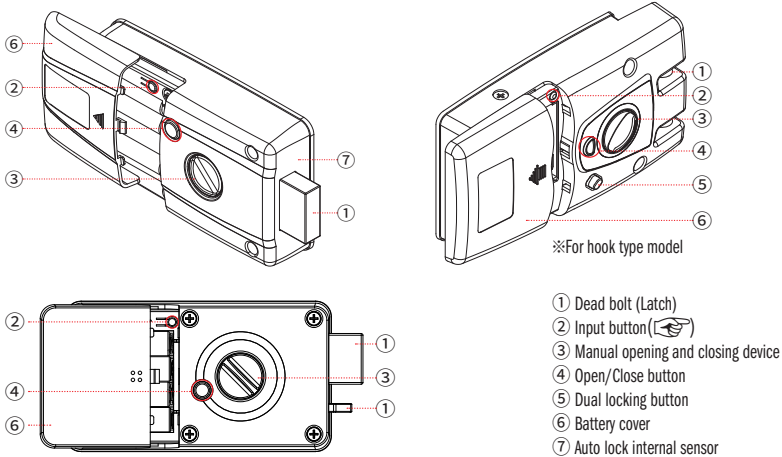

- Open /Close button: One touch button which is used to open or close door from inside
- Input button(👉): Used when registering password or registering/deleting card/key tag or remote control.
- Manual opening and closing device: Used to manually open and close door (Use this function in case of fire or other emergencies)
- Dead bolt (Latch): Indoor latch for door lock
- Auto lock internal sensor: Built-in sensor which is automatically locked when auto lock is set
- Fire detection sensor: Built-in fire detection sensor to automatically open a door in case of fire (60°C±10°C)

1. Master Mode

Set in Master Mode

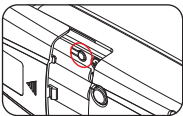

A. Setting master control password : Inputting Master control password is required when change password or register/delete cards/remotes.

1. Press "Input button" in the indoor body.
2. Press "0" and "#" in order.
3. Register a new master control password. (3~19digits)
4. Press "*" button to complete. "Ding-dong" for success / "3 short Beep" sound for failure will occur.

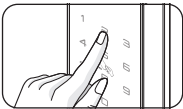

B. Changing master control password

1. Press "Input button" in the indoor body
2. Enter the Master control password and "*" button.
3. Press "0" and "#" in order.
4. Register a new master control password. (3~19digits)
5. Press "*" button to complete.

※ In the state of Master mode, it always make two short beep sound whenever "Input button" is pressed.
 ※ Master control password can be used to unlock the door like the same way of user password.

Registering/Changing User Password In Master Mode

A. Registering User Password

1. Press "Input button" in the indoor body. (two short beep sound)
2. Enter the Master control password and "*" button.
3. Register User password and "*" button to complete. "Ding-dong" for success / "3 short Beep" sound for failure will occur.

B. Changing User Password

※ Change password in the same way as above. ※ When registering new password, previous password is automatically deleted.

※ **Caution** - Make sure that a door keeps being open when registering/changing password.

- Default factory password is set to "1234". Please update the password after installation.
- To go to the next stage, perform it before the lamp turns off (within 15 seconds).

Registering/Deleting User Card In Master Mode (Applied model)

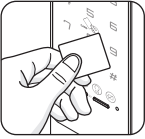

A. Registration

1. Press "Input button" in the indoor body. (two short beep sound)
2. Enter the Master control password and "*" button.
3. Contact each Smart card to be registered to the external input part in the outdoor body.
Up to 50 Cards can be registered.
4. Press "*" button to complete. "Ding-dong" for success / "3 short Beep" sound for failure will occur.

B. Deletion

1. Press "Input button" in the indoor body. (two short beep sound)
2. Enter the Master control password and "*" button.
3. Press "0" button two times and "*" button to complete.

※ Caution

- If deleting card/key tag, all registered Cards/Key tags will be deleted. Then, newly register Cards/Key tags to be used.
- For card/key tag model, please use and register only card/key tag provided by us.
- We are not liable for any security incident if user uses other cards or tags. (Such as traffic card, credit card, etc) rather than dedicated card/key tag.

Registering/Deleting Remote control In Master Mode (Applied model)

A. Registration

1. Press "Input button" in the indoor body. (two short beep sound)
2. Enter the Master control password and "*" button.
3. Press "0", "#" button in order
4. Press the open/close button on the Remote.
5. Press "*" button to complete. "Ding-dong" for success / "3 short Beep" sound for failure will occur.



Open/Close button

B. Deletion

1. Press "Input button" in the indoor body. (two short beep sound)
2. Enter the Master control password and "*" button.
3. Press "5" button two times and "*" button to complete.

※ Remote control can be registered up to 15ea.

※ Door is closed or opened within 2~3 seconds after pressing the button.

※ Caution : If deleting remote, all registered remotes will be deleted. Then, newly register Remotes to be used.

Registering/Deleting Fingerprint in Master Mode (Applied model)

※ Slide the cover to open the fingerprint scanner

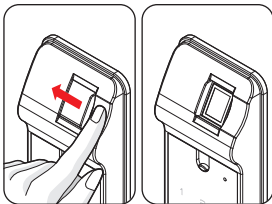

A. Registration

1. Press "Input button" in the indoor body. (two short beep sound)
2. Enter the Master control password and "*" button.
3. Push the scanner cover to leftside and input a fingerprint to be registered on the scanner primarily until first "beep" sound.
4. Put the same fingerprint on the scanner secondarily until second "beep, beep" sound.
5. Re-put the same fingerprint on the scanner thirdly until third "beep, beep, beep" sound.
6. Lastly put the same fingerprint fourthly until "ding-dong-dang" sound to inform successful registration.
7. Press "*" button to complete registration.

※ Caution - Keep the finger placing on the scanner until it makes sounds.

- When failed to register, start from the first step again.

- Up to 100 fingerprints can be registered.

B. Deletion

1. Press "Input button" in the indoor body. (two short beep sound)
2. Enter the Master control password and "*" button.
3. Press "0", "1" and "*" button in order to complete deletion.

※ Notice

- The deletion of fingerprints causes all the existing, registered ones to be deleted.
- After the deletion, register the fingerprints to be used a new.
- The fingerprints of infants in the developmental stage or some users with unique fingerprints (those which cannot be registered) may not be recognized.
- Scanning foreign substance (sweat and moisture)-stained fingerprints or dry fingerprints may lead to failure to recognize fingerprints.
- Stay clean the fingerprint input unit so it is not stained with foreign substances and do not use a wet finger.
- If fingerprint recognition is not successful, input and use the fingerprints of another finger.
- Registered fingerprints may be also registered in a duplicate manner.

2. Revert to Non-Master mode from Master mode

No need to input master password when change/password or register/delete cards/remotes.

1. Press "Input button" in the indoor body.
2. Input the registered master control password.
3. Press "※", "0", "#", "0", "0", "※" button in order to complete.

Remark: In the state of Non-Master Mode, it always make one short beep sound whenever "Input button" is pressed.

Registering/Changing User Password In Non-Master Mode

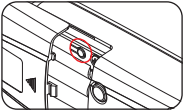

A. Setting User-password

1. Open the battery cover in the indoor body.
2. Press "Input button". (one short beep sound)
3. Input the new password. Up to 4 to 19 digits can be registered.
4. Press "※" button to complete the registration.
"Ding-dong" for success / "3 short Beep" sound for failure will occur.

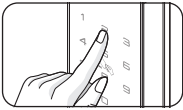

B. Changing User-password

- ※Change password in the same way as above.
- ※When registering new password, previous password is automatically deleted.

Registering/Deleting User Card In Non-Master Mode (Applied model)

A. Registration

1. Open the battery cover in the indoor body.
2. Press "Input button". (one short beep sound)
3. Contact each Smart card to be registered to the external input part. Up to 1 to 50 keys can be registered.
4. Press "※" button to complete the registration. "Ding-dong" for success / "3 short Beep" sound for failure will occur.

B. Deletion

1. Open the battery cover in the indoor body and press "Input button" one time.(one beep short sound)
2. Press "0" button two times in the number pad in the outdoor body.
3. Press "※" button to complete the deletion

※Caution : If deleting Smart card, existing registered Smart card are completely deleted.
Then, newly register Smart card to be used.

Registering/Deleting Remote control In Non-Master Mode (Applied model)

A. Registration

1. Press "Input button" in the indoor body. (one short beep sound)
2. Press "0", "#" button in order
3. Press the open/close button on the Remote.
4. Press "※" button to complete. "Ding-dong" for success / "3 short Beep" sound for failure will occur.

B. Deletion

1. Press "Input button" in the indoor body. (one short beep sound)
2. Press "5" button two times and "※" button to complete.



- ※Remote control can be registered up to 15ea.
- ※Door is closed or opened within 2~3 seconds after pressing the button.
- ※Caution : When deleting remote, existing registered Remotes are completely deleted. Then, newly register Remotes to be used.

■ Product Warranty (For customer use)

※Please fill up all details when purchasing a product and present this warranty when requesting repair service.

Product Name				
Production code				
Date of purchase		() year & () months from date of purchase (Day	Month	Year)
Customer	Name			
	Address			
Store (Installation shop)	Name	Tel:		
	Address			

About product warranty

1.This product is manufactured under the strict quality management and inspection. 2.Free A/S for within warranty period is provided for any technical problem if a product is used in a normal circumstance. Even within warranty period, if a case is matching with items described in paid service guide, service charge (Repair, parts and travel fee) will apply. 3.It is required to present this warranty card when requesting repair service. 4.Please keep this warranty card carefully as it is not re-issuable. 5.When re-installing a product due to relocation or more, installation and travel fee will apply. 6.A product cannot be returned or exchanged after installation except in case of serious defect of a product. (It is in accordance with compensation criteria for consumers' damages.)

Requesting service

1.Please check instructions in user manual and check-list in case of malfunction prior to contacting us. 2.If the problem persists, stop using a product and contact sales agency/HQs. ※It is very dangerous to try to repair a product yourself. ※Please provide the following information when contacting us: Model name, date of purchase and place of purchase / Address, name, contact number and home address / Symptoms (In detail)

■ Compensation Criteria for Consumers' Damages

Type of consumer damages		Compensation	
		Within warranty period	After warranty period
Normal usage	Malfunction	Free service	Paid service
	Malfunction which identical defect occurs twice	Free service	Paid service
	When parts for repair is not available	Exchange	Exchange (In accordance with the declining balance method of depreciation)
Consumer's intention or mistake	User error such as incorrect battery replacement, incorrect input, etc	Paid service	Paid service
	Replacement of consumables (such as battery)	Paid service	Paid service
	Malfunction or damage caused by using a product for other purposes	Paid service	Paid service
	Malfunction or damage is made intentionally	Paid service	Paid service
Malfunction or damage caused by fire or natural disaster		Paid service	Paid service

Free/paid service (Criteria in detail)

Service fee is charged in accordance with Consumer Protection Act. (Based on Article 5. Compensation Criteria for Consumers' Damages, Consumer Protection Act.) Service fee consists of part cost and travel repair fee and each fee is determined by the followings. Service fee = part cost + travel repair fee (Repair service fee)

■ Free repair: Problems in performance or function occurred within warranty period while using a product in normal way.

■ Paid repair: After warranty period or in the following cases within warranty period

In case of 'User error' / Service request for How-to question or forgotten password (Loss of key) / Request to check up product without precise defect / Malfunction after installing a product by consumer / Damage caused by external impact / Malfunction caused by incorrect way of inserting or replacing batteries / Damaged cover when consumer replaces battery / Malfunction or quality issue caused by using chemical materials / Request for re-installation due to faulty installation (Alter front location)

For models with emergency key, product damage caused since consumer did not take emergency with him/her / Product malfunction caused by condensation

■ Part cost: Part cost refers to cost of part(s) which is required for product repair

■ Travel repair fee: Travel repair fee applies to paid service and is total of technical fee in accordance with required level of difficulty (Time) and travel fee.

Registering/Deleting Fingerprint in Non-Master Mode (Applied model)

※ Slide the cover to open the fingerprint scanner

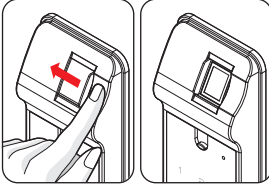

A. Registration

1. Press "Input button" in the indoor body. (one short beep sound)
2. Slide the scanner cover to leftside and put a fingerprint to register on the scanner until first "beep" sound.
3. Put the same fingerprint on the scanner secondarily until second "beep, beep" sound.
4. Re-put the same fingerprint on the scanner thirdly until third "beep, beep, beep" sound.
5. Lastly put the same fingerprint fourthly until "ding-dong-dang" sound to inform successful registration.
6. Press "*" button to complete registration.

※ **Caution** : - Keep the finger placing on the scanner until it makes sounds.
- When failed to register, start from the first step again.
- Up to 100 fingerprints can be registered.

B. Deletion

1. Press "Input button" in the indoor body. (one short beep sound)
2. Press "0", "1" and "*" button in order to complete deletion.

※ **Notice**

- The deletion of fingerprints causes all the existing, registered ones to be deleted.
- After the deletion, register the fingerprints to be used a new.
- The fingerprints of infants in the developmental stage or some users with unique fingerprints (those which cannot be registered) may not be recognized.
- Scanning foreign substance (sweat and moisture)-stained fingerprints or dry fingerprints may lead to failure to recognize fingerprints.
- Stay clean the fingerprint input unit so it is not stained with foreign substances and do not use a wet finger.
- If fingerprint recognition is not successful, input and use the fingerprints of another finger.
- Registered fingerprints may be also registered in a duplicate manner.

3. Common Features

Open a door with Fingerprint, Card/Key tag from outside



A. Card/Key tag model

Place the registered Card / key tag on external touch key pad.
(Ding dong sound)



CARD
Card/key tag pad

B. Opening the door with fingerprints

Contact the registered fingerprints with the fingerprint input.
("Beep" sound)

Open a door using password from outside

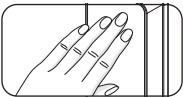

1. Press more than 2 buttons on outdoor keypad (Beeping sound / Keypad flashes) to turn on the light of touch pad.
2. Enter password and press * button to open a door.



Caution

- ※ After failure to input valid password in 5th attempt, operation will not be available for about 1 minute.
- ※ Please try it again after 1 minute when the operation is suspended.

Open a door from inside

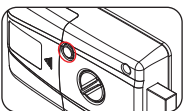

Press open/close button to open a door.



Caution

- ※ Use manual opening/closing device only in case of fire or other emergencies.

Lock a door from outside

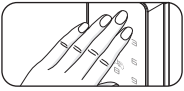

- ▣ **On auto mode** : Door will be automatically locked in 1 second after closing the door.
- ▣ **On manual mode** : Press more than 2 buttons on touch keypad of outdoor body.

Lock a door from inside

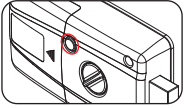

- ▣ **On auto mode** : Door will be automatically locked 1 second after closing the door.
- ▣ **On manual mode** : Press 'open/close' button to lock a door.



※Use manual opening/closing device only in case of fire or other emergencies.

Reset function (Applied model with reset function)

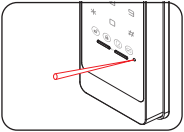

※Function to reset program by pressing Reset button in case of temporary error rather than product malfunction.

- ▣ **Applied model with Reset button**

Press Reset button using a sharp object such as ballpoint pen, toothpick, etc

※Even after applying reset, registered password and touch key (card/key tag) will not be changed.

External dual locking function (Applied model with external dual locking function)

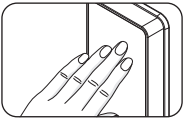

- ▣ **Enable** : Press more than 2 buttons on touch keypad of outdoor body → Press and hold # button on outdoor body for more than 5 seconds to enable dual locking function
- ▣ **Disable** : Press more than 2 buttons on touch keypad of outdoor body → Enter registered password → Press * button to disable the function

Inside dual locking function

※Once inside dual locking function is enabled, a door will not open even though entering valid password from outside.

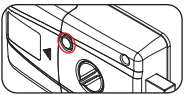

- ▣ **Model without dual locking button**



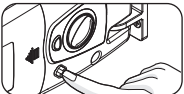

- Enable: Press and hold open/close button for more than 5 seconds (Ding dong sound)
- Disable: Press open/close button to disable the function and open a door



- ▣ **Model with dual locking button**

Turn dual locking button to red on indoor body while a door is closed, then a door will not open even though entering valid password or card/key tag from outside.

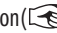
Set auto/manual locking (Convenient function to automatically lock 1 second after closing a door)

- Auto lock: Open battery cover and press Input button() → Press # button → Press Input button() (Ding dong sound)
- Manual lock: Open battery cover and press Input button() → Press # button → Press Input button() (One short beep sound when set to manual lock mode)

- ▣ **Set auto locking time** (Change auto lock time to 2 ~ 9 seconds)

Press Input button on indoor body → Press 8 → Press time you wish to set (2~9 button) → Press * button

Other useful functions

■ Function to prevent password exposure (Fake number function)

- Hide password by pressing password after entering random numbers

■ Alert function

- Locking error alert function:

When a door is not properly closed, it makes 3 attempts to open the door and generate beeping sounds to alert.

- Intrusion and prank prevention function:

Function to generate emergency alarm for 1 minute to prevent intrusion when there is an attempt to open a door by force.

※Enter password or card/key tag to turn off the alarm.

■ Sound settings

- Adjust sound (Low → High volume):

Press internal Input button(👉) → Press 1, 3, and * in order → Press "1" button several times to turn down volume or "3" button several times to turn up the volume (Low to High volume) → Press * button

※The volume of sound can be adjusted in 6 steps.

■ Fire detection function (Built in fire detection sensor)

- When heat detection sensor detects heat ($60^{\circ}\text{C}\pm 10^{\circ}\text{C}$), it automatically opens a door.

※When indoor body is exposed to direct sunlight for a long period of time, the temperature sensor may generate alarm.

■ Function to open a door using outside emergency key (Applied model with emergency key)

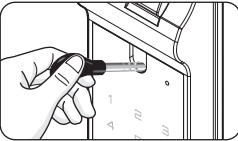

The function allows opening a door using emergency key in case of emergency or other particular situations. Slide up the emergency hole cap, insert emergency key to the hole and turn around the key.

※Use this key in emergency cases. Alarm sounds when using emergency key.

※Always take the emergency key with you in case of emergency.

External alarm function (Applied model with external alarm icon function)



■ **Door unlocking** : The door has been successfully unlocked with password or card/key tag.



■ **Door locking** : The door has been locked.



■ **Password error** : Re-enter the correct password to unlock the door.



■ **Low battery** : Replace all batteries with new one.

Change battery

When installed batteries are going flat, lamp flashes 7 days before and generate melody to inform battery change.

In this case, replace all batteries with new one. Password or Card/Key tag will not change even after replacing the batteries.



Caution

※Product life span cannot be guaranteed if used batteries are used together with new one. It is required to use quality alkaline battery. When using rechargeable battery, product can cause malfunction.

※Please check battery polarity (+/-). Polarity reversal may cause malfunction. Consumer is liable for any damage caused by faulty battery and make sure to use quality alkaline battery only.

Unlock a door with emergency battery

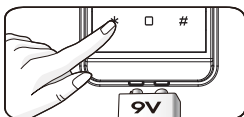

When batteries are completely flat after long term travel, the emergency power supply function allows safe unlocking of a door. Purchase DC9V alkaline battery, contact it to emergency socket on outdoor body and apply password, fingerprint or card/key tag.

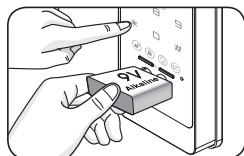

Caution

※ Make sure that battery is properly contacted with emergency socket when using this function. (External emergency power supply socket does not have polarity).

※ Location of external emergency power supply socket may differ according to the product model.

■ Unlock a door using password

Contact 9V battery to emergency socket → Press more than 2 buttons to turn on the light of touch pad and enter password → Press * button to unlock

■ Unlock a door using fingerprint, card/key tag (Applied model with fingerprint, card/key tag)

Contact 9V battery to emergency socket and place fingerprint, Card/Key tag on external input pad to unlock a door.

Fault diagnosis and troubleshooting

Symptoms	Troubleshooting
Cannot remember password	- Open a door using card/key tag and register new password (number-dedicated models excluded)
Password input failure (5 attempts)	- All functions are not available for 1 minute after failure of 5th attempt. Wait for 1 minute and set new password or card/key tag.
Door is not automatically locked	- Check if auto locking function is enabled
* button is not working	- If other functions are not working, check if batteries are properly inserted. If batteries are flat, replace them with new batteries.
External button sound is not working and lamp is not flashing	- Check if there is any liquid leakage on battery case or product and if so, wipe out contact area with a dry cloth.

Product specifications

Type		Specification
Basic items	Use password	3 ~ 19 digits
	The number of Cards/Key tags to be registered	Up to 50 (Applied models with card/key tag)
	The number of remote control to be registered	Up to 15 (Applied models with remote control)
	The number of fingerprints to be registered	Up to 100 (Applied models with the input of the fingerprints)
	Thickness of door	40 ~ 50 mm
Power supply	Power source	6V (AA Size 1.5V Alkaline Battery X 4EA)
	Emergency power source (Do not have polarity)	9V square alkaline battery (Purchase separately)